

METAL FRAME SYSTEMS WITH SAME FUNCTION

DRYWALL	MAIN BAR	CROSS BAR	WALL ANGLE	APPLICATION	
PREMIUM	VINH TUONG V-SHAFT				Elevator car panels Emergency staircase panels Service riser walls Office partition panels
STANDARD	VINH TUONG V-WALL				Office walls Hotel room walls High-grade apartments Audio-visual rooms
ECONOMY	VINH TUONG E-WALL				Office partition panels Apartments

SUPPORTING TOOLS FOR HOUSE OWNER:

- 1 Mobile Application "Enjoy new living space with gypsum of Vinh Tuong – Gyproc"
- 2 Vinh Tuong software for calculating ceiling and drywall material.
- 3 "Nhịp song thi công" magazine
- 4 Clips for using jointing powder DURAFlex/ Gyproc
- 5 Clips for installing ceiling and drywall



TOTAL CEILING & DRYWALL SOLUTION

After over 25 years of constant growth from its founding as a building material shop in 1991, Vinh Tuong is now proud to be the most recognized brand in Vietnam in solutions and products for ceiling and drywalls, boosting a growth rate of 500% over the past five years. The company's quality management system complies with ISO 9001:2008 quality management system certified by SGS. Our products meet ASTM and BS standards and are warranted up to 10 years. Vinh Tuong is among the top 100 Vietnam Gold Star Award for many consecutive years, and ranked among the top 10 leading private construction material manufacturers as well as among the top 500 largest private enterprises in Vietnam (VNR500)

www.vinhtuong.com
www.tranhadep.com

18001218

GOLD PRODUCTS
GOLD QUALITY
GOLD SOLUTIONS



SUSTAINABLE QUALITY
. High-quality steel materials from NS BlueScope (Australia)
. Metal frames are provided with 10 years warranty (*)
DIVERSE SOLUTIONS
The product range is wide and diverse, suitable for all demands, entirely meeting the aesthetic requirements and specialized requirements
RELIABLE SERVICE
Vinh Tuong products are available in Vietnam, Australia, Myanmar, Sri Lanka, Singapore and proud to be in many iconic projects such as Sentosa (Singapore), Venetian (Macau), Keangnam (Vietnam),...

- SOUTHERN Office: M Floor, IPC Building, 1489 Nguyen Van Linh, District 7, HCMC
CENTRAL Street 9, Hoa Cam industrial zone, Cam La district, Da Nang City
NORTHERN Office: Floor 14, LILAMA 10 Building, To Huu Road, Ward Trung Van, District Nam Tu Liem, Hanoi
VTJ SINGAPORE No.4 Chin Bee Road Singapore 619819

For further information, please contact us via toll free:

This manual takes effect from 01.01.2017 and automatically replaces previously-published documents. The contents may be changed without prior notice. Please visit www.vinhtuong.com for the latest updates.

VINH TUONG V-SHAFT PREMIUM DRYWALL SYSTEM

VINH TUONG V-SHAFT is used for high fire-resistant demand areas such as: walls for elevators, emergency exit, technical box,... Vinh Tuong V-Shaft is proud to appear in: Kumho (HCMC), Keangnam (Ha Noi), Nhà máy Samsung E&C Q.9 (TP.HCM)...

Advantages of VINH TUONG V-SHAFT :

- Light, easy for installation or maintenance of M&E systems
- Best performance for fire-resistant as well as sound-proof

Inkjet printing VINH TUONG

VINH TUONG logo is embossed



PERSPECTIVE

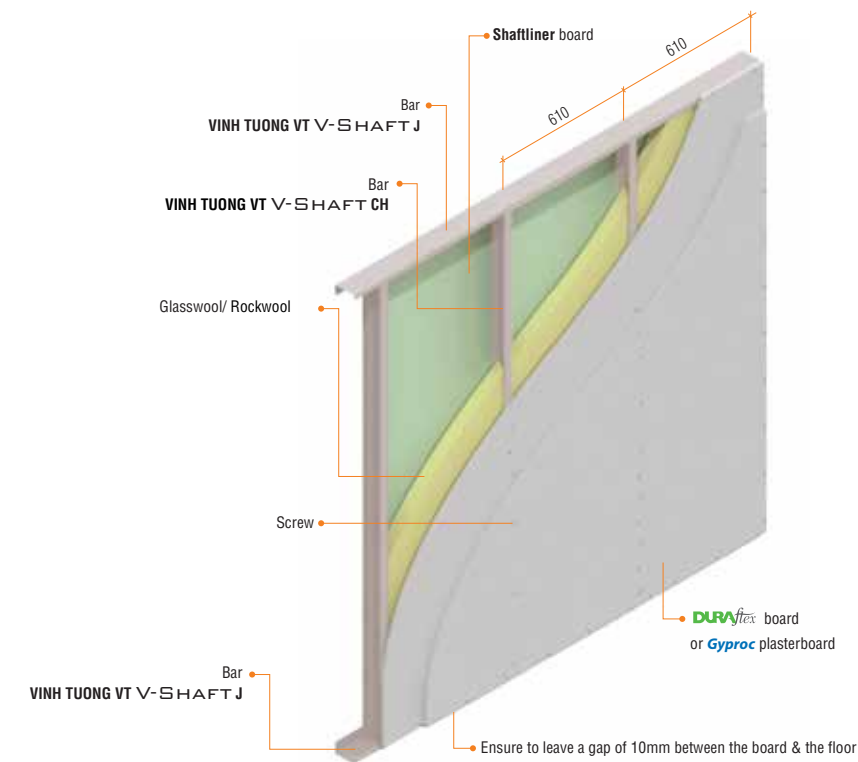

COMPOSITION AND SPECIFICATION

Bar type

Length (mm)
Thickness (mm)

VINH TUONG VT V-SHAFT CH bar

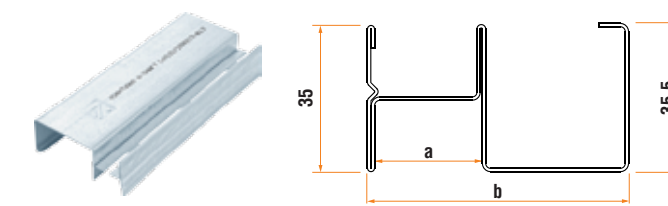

With a = 16 or 25
b = 63 100
76 125
92 150

3000
0.8 ± 0.03

VINH TUONG VT V-SHAFT J bar

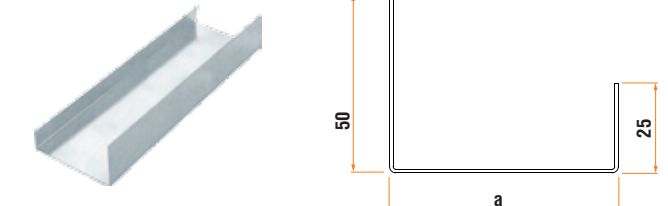

With a = 65 102
78 127
94 152

2700
0.8 ± 0.03

Corner Bead V: VTV30/30 ; VTV40/40



2700
0.50 ± 0.02 0.50 ± 0.02
VTV30/30: W = 30 VTV40/40: W = 40



APPLICATION

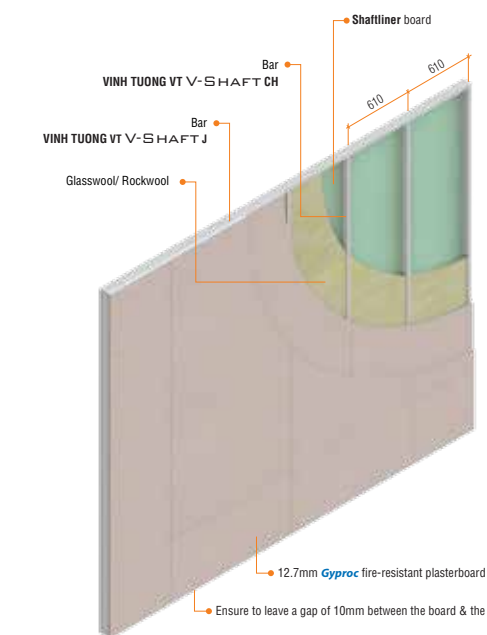

FIRE RESISTANT DRYWALL - 120 MINUTES
Using 12.7mm Gyproc fire-resistant plasterboard

ADVANTAGES OF VINH TUONG'S FIRE RESISTANT SOLUTION

- Stopping or slowing the fire spread from firing place to other areas of the building in order to minimize the destruction and lengthen the time for people to evacuate"
- Maximally protecting users and the building by optimizing the fire resistance and thermal resistance
- Helping users carry out the provisions of the Law of Fire Protection and Prevention
- Applying the diverse aestheticism to various interior styles with a wide range of material choices



RECOMMENDATIONS

- 4 BASIC TIPS FOR CONSTRUCTION TO HAVE INSIDE DURABILITY AND OUTSIDE BEAUTY**
1. The distance between the two vertical bars is 610mm
 2. The distance to drive screws is 200mm at board edges and 300mm coincidence inside boards
 3. Boards should be staggered, not inside boards



- Right: High bearing capacity of walls, thus higher durability
- Right: The connection between boards and frames is secure, increasing durability for the system
- Right: Minimizing drywall cracks
- Wrong: Poor bearing capacity of walls, thus lower durability
- Wrong: The connection between boards and frames is weak and unaesthetic
- Wrong: Difficult to handle and easy to cause drywall cracks

4. Using DURAflex - Jointing Powder for calcium silicate boards to achieve perfection in completing the ceiling system



RECOMMENDATIONS OF VINH TUONG

1. Synchronously use Vinh Tuong's products: frames, boards, and accessories to ensure system stability.
2. Using ceiling/wall with additional features of thermal resistant, moisture-resistant, sound insulation... Visit www.vinhvuong.com or www.trannhadep.com for more information.
3. Installers with Vinh Tuong occupation cards are recommended to ensure professional installation.



For more information, please contact us via toll free 1800 1218

VINH TUONG BOARDS RECOMMENDED FOR DRYWALL SYSTEM